



INSTALLATION

UNDER TOUR TRUNK L.E.D. ACCENT

3231

PARTS INCLUDED

- 1 Right Under Trunk Accent
- 1 Left Under Trunk Accent
- 1 Run-Turn "Y" Wiring Harness
- 2 Alcohol Pads
- 2 Dielectric Grease Packets
- 6 Cable Ties
- 1 Double "Y" Connector
- 1 Installation Instructions

Please read and understand entire instructions before starting installation.

THANK YOU FOR CHOOSING KÜRYAKYN!

IN ORDER TO PROTECT YOU AND OTHERS FROM POSSIBLE INJURY AND/OR PROPERTY DAMAGE OR LOSS, PLEASE PAY CLOSE ATTENTION TO ALL INSTRUCTIONS, WARNINGS, CAUTIONS AND NOTICES REGARDING THE USE AND CARE OF THIS PRODUCT.

WARNING

THIS INDICATION ALERTS YOU TO THE FACT THAT IGNORING THE CONTENTS DESCRIBED HEREIN CAN RESULT IN POTENTIAL DEATH OR SERIOUS INJURY.

NOTICE

This indication alerts you to the fact that ignoring the contents described herein may negatively affect product performance and functionality.

NOTICE

IF INSTALLING THIS PRODUCT FOR ANOTHER PARTY, PLEASE MAKE SURE THEY RECEIVE THIS COPY OF THE INSTALLATION INSTRUCTIONS SO THEY ARE AWARE OF THE IMPORTANT INFORMATION CONTAINED IN THEM.

TOOLS SUGGESTED

Set of Metric Hex Wrenches

STRICTLY OBSERVE THE FOLLOWING GUIDELINES IN ORDER TO USE THE PRODUCT PROPERLY AND AVOID POTENTIALLY DANGEROUS ACCIDENTS.

STEP 1

Read and understand all steps in the instructions before starting the installation. Park the motorcycle on a hard, level surface and turn off the ignition.

NOTE: This product requires the motorcycle to be equipped with Kuryakyn Rear Accessory Plug and Play Harness, P/N 3230, purchased separately.

NOTICE

A factory service manual may be helpful in performing this installation. Do not attempt to perform this installation if you are not confident in your ability to complete all of the steps in the procedure; consult a trained technician.

-cont.-

3231-21GL-0812



CUSTOMER SERVICE

877.370.3604 (toll free)

INSTALLATION QUESTIONS

techsupport@kuryakyn.com
or call 715.247.2983

LIMITED WARRANTY

Kuryakyn warrants that any Kuryakyn products sold hereunder, shall be free of defects in materials and workmanship for a period of one (1) year from the date of purchase by the consumer excepting the following provisions:

- Kuryakyn shall have no obligation in the event the customer is unable to provide a receipt showing the date the customer purchased the product(s).
 - The product must be properly installed, maintained and operated under normal conditions.
 - Kuryakyn makes no warranty, expressed or implied, with respect to any gold plated products.
 - Kuryakyn shall not be liable for any consequential and incidental damages, including labor and paint, resulting from failure of a Kuryakyn product, failure to deliver, delay in delivery, delivery in nonconforming condition, or for any breach of contract or duty between Kuryakyn and a customer.
- Kuryakyn products are often intended for use in specific applications. Kuryakyn makes no warranty if a Kuryakyn product is used in applications other than intended.
- Kuryakyn electrical products are warranted for one (1) year from the date of purchase by the consumer. L.E.D.'S contained in components of Kuryakyn products will be warranted for defects in materials and workmanship for 3 years from the date of purchase where as all other components shall be warranted for one(1) year. This includes, but is not limited to; control modules, wiring, chrome & other components.
- Kuryakyn makes no warranty of any kind in regard to other manufacturer's products distributed by Kuryakyn. Kuryakyn will pass on all warranties made by the manufacturer and where possible, will expedite the claim on behalf of the customer, but ultimately, responsibility for disposition of the warranty claim lies with the manufacturer.

ABOUT OUR CATALOG

For purchasing Kuryakyn® products, you can receive a complete catalog free of charge.

Send the Proof-of-Purchase below with your address to: Kuryakyn, P.O. Box 339, Somerset, WI 54025.

Please indicate either Accessories Catalog for Harley-Davidson® or GL & Metric Cruisers.

Be sure to ask your local dealer about other Kuryakyn® products, the motorcycle parts and accessories designed for riders by riders.

©2005 Kuryakyn USA® All Rights reserved.



kuryakyn.com

STEP 2 Determine the left from the right (sitting on bike) Accent. PIC 1

STEP 3 Thoroughly clean the area on the top of both saddle bags as shown in PIC 2. Use soapy water and a clean rag. Rinse and dry completely. Wipe the area with the included alcohol pads to remove any residue. Let dry completely.

NOTICE Ensure the area of installation is free of grease, oil, dirt or other debris including wax/polish products and bugs to ensure proper adhesion. Küryakyn WILL NOT issue a warranty on any parts lost due to improper installation.

STEP 4 Test fit the left side Accent to the top of the left saddlebag. The Accent will follow the seam between the saddlebag door and the saddlebag and the inside seam between the top of the saddlebag and the trunk. The rear of the Accent will fit up to the edge above the turn signal. **Make sure that Accent is placed inboard far enough that the saddlebag door can open and close without hitting the Accent.** Make any reference marks on the saddlebag with a non-permanent marker or masking tape. PIC 3

NOTICE The adhesive will not bond correctly if applied at temperatures less than 50°F. Do not attempt this installation in temperatures less than 50°F.

STEP 5 Rub the backing of the adhesive with the back of your fingernail to activate the adhesive. Remove the backing. Make sure the wire harness is tucked in behind the Accent and follows to the front of the Accent. Using any reference marks made in Step 4, firmly press the Accent in place for one minute. Full bond will occur in 24 hours. Tuck the harness up under the passenger armrest to under the seat. PIC 4

NOTE: If the motorcycle is to be operated before the 24 hour cure time has expired, use a good quality masking or painter's tape over the Accent to assist in holding the Accent in place until the cure time is over.

STEP 6 Repeat Steps 4 and 5 for the right side.

STEP 7 Remove the seat and the rear fender panel as outlined in the service manual. PIC 5

STEP 8 Route the wire harnesses from each Accent along the OEM harness on each side of the trunk to the center of the motorcycle under the seat. PIC 6 Use the included nylon cable ties to secure them out of harms way.

NOTICE Küryakyn recommends the use of dielectric grease on electrical connections.

STEP 9 Locate the Run-Turn "Y" harness. Apply some of the included dielectric grease to the three pin connector marked LEFT (with the ORANGE, RED and BLACK wires) and connect it to the Accent attached to the top of the left (sitting on bike) saddlebag. Apply some of the included dielectric grease to the three pin connector marked RIGHT (with the BLUE, RED and BLACK wires) and connect it to the Accent on the top of the right saddlebag.

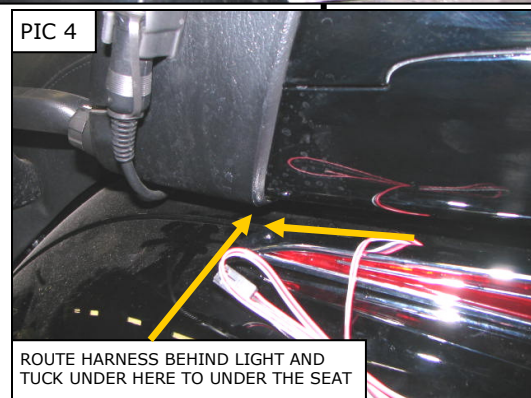
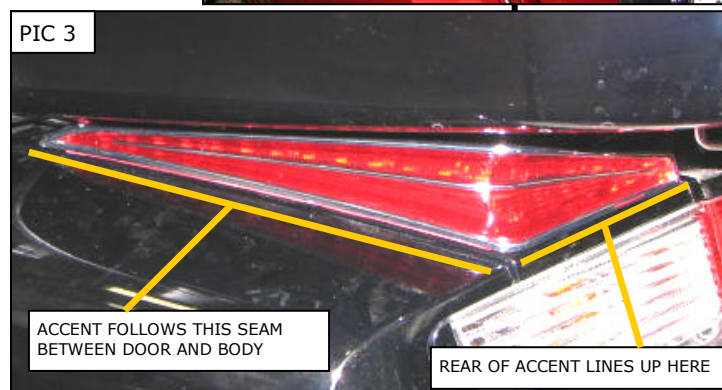
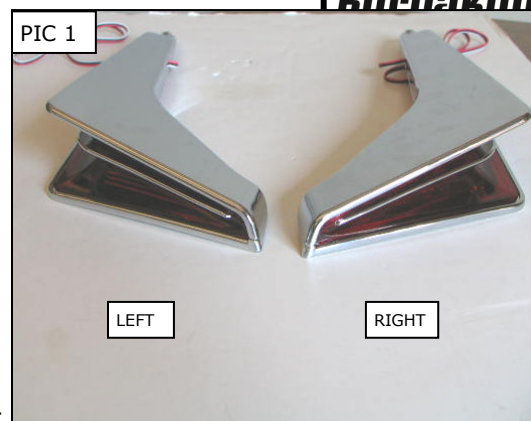

STEP 10 Requires the separate purchase and installation of Küryakyn P/N 3230 to complete installation. Route the six pin connector on the end of the Run-Turn "Y" harness under the seat, and along the main harness (along the frame on the **RIGHT** side of the motorcycle, PIC 7), to the rear of the motorcycle. It may be helpful to use a guide wire. Use the included cable ties to secure the harness out of harms way.

NOTICE Secure all wiring away from any moving parts, pinch points or extreme heat. Küryakyn **WILL NOT** issue a warranty on any electrical component that fails due to pinched, crimped, broken, abraded, melted or frayed wires.

NOTICE Küryakyn recommends the use of dielectric grease on electrical connections.

STEP 11 Please refer to the instructions for P/N 3230: If you have an open six pin connector on the Plug and Play Harness (P/N 3230), apply some of the included dielectric grease and connect the six pin connector from the Run-Turn "Y" harness to it. If you do not have an open connector, disconnect one of the six pin sets, apply some of the included dielectric grease to all connectors and connect the included Double "Y" connector in line. PIC 8 Connect the existing accessory and the Accent Lights to the new Double "Y" connector. Use the included cable ties to secure the harness out of harms way.

NOTICE Secure all wiring away from any moving parts, pinch points or extreme heat. Küryakyn **WILL NOT** issue a warranty on any electrical component that fails due to pinched, crimped, broken, abraded, melted or frayed wires.

STEP 12 Turn the motorcycle on and verify that all lights work correctly.

WARNING ENSURE PROPER LIGHT OPERATION BEFORE RIDING THE MOTORCYCLE. VISIBILITY IS A MAJOR CONCERN FOR MOTORCYCLISTS. A LIGHT MALFUNCTION COULD RESULT IN DEATH OR SERIOUS INJURY.

STEP 13 Replace the seat and the rear fender panel.

WARNING AFTER INSTALLING THE SEAT, PULL UP ON IT TO ENSURE IT IS LOCKED INTO PLACE. A LOOSE SEAT CAN SHIFT AND CAUSE LOSS OF CONTROL RESULTING IN SERIOUS INJURY OR DEATH.

NOTICE It is the installer's responsibility to ensure that all of the fasteners (including pre-assembled) are tightened before operation of the motorcycle. Küryakyn will not issue a warranty on components lost due to improper installation. Periodic maintenance may be required.

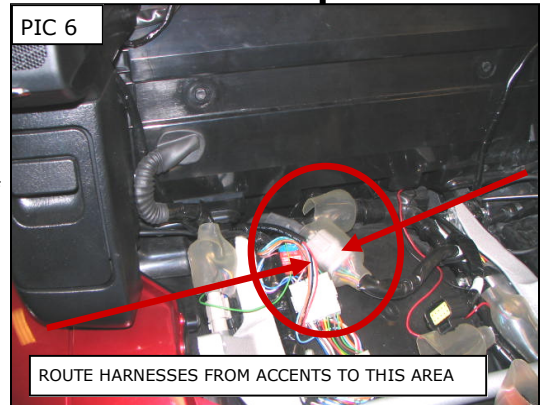
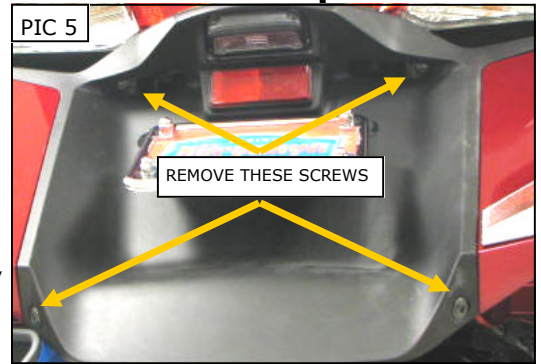

RIGHT SIDE UNDER PASSENGER SEAT SHOWN IN BOTH PICTURES

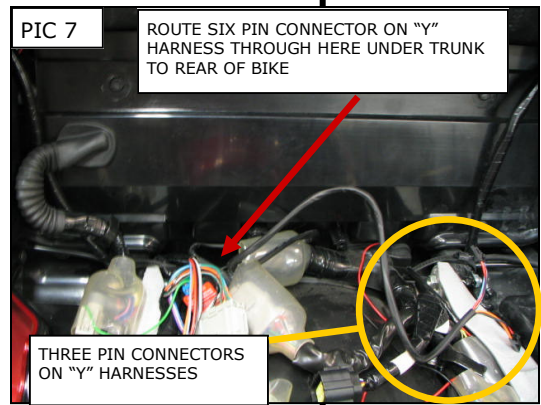

PIC 8

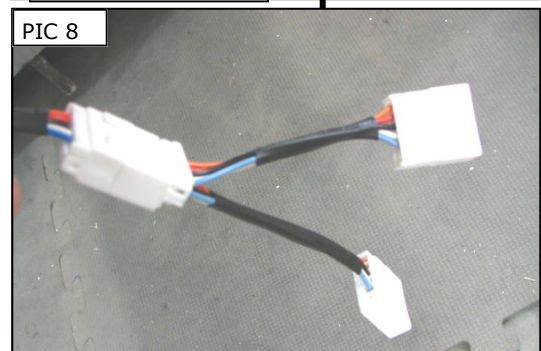

Ride On!